

mistral

Tower Fan MFD1803R

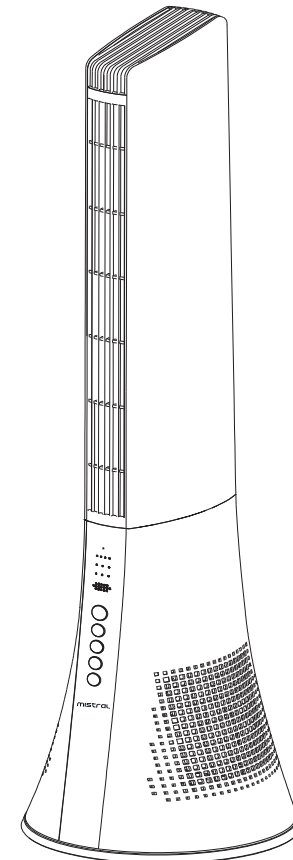

Please read this instruction manual thoroughly before operating and keep it for future reference

Warranty & Customer Service

SCAN FOR



e-Warranty

e-Warranty Registration at www.khind.com.my/e-warranty.html

MAYER MALAYSIA SDN BHD

Customer Service Hotline: 1800-88-0032

Service Centre Operating Hours:

8.30am – 6.00pm (Monday - Friday)

Closed on Saturday, Sunday and Public Holidays

No. 2, Jalan Astaka U8/82, Bukit Jelutong, 40150 Shah Alam, Selangor D.E., Malaysia.

Waranti & Perkhidmatan Pelanggan

IMBAS UNTUK



E-Waranti

Pendaftaran e-Waranti di www.khind.com.my/e-warranty.html

MAYER MALAYSIA SDN BHD

Hotline Perkhidmatan Pelanggan: 1800-88-0032

Waktu Operasi Pusat Perkhidmatan:

8.30am – 6.00pm (Isnin-Jumaat)

Ditutup pada hari Sabtu, Ahad dan Cuti Umum

No. 2, Jalan Astaka U8/82, Bukit Jelutong, 40150 Shah Alam, Selangor D.E., Malaysia.

IMPORTANT SAFETY INSTRUCTIONS

- This appliance is not intended for use by persons (including children) with reduced physical, sensory or mental capabilities, or lack of experience and knowledge unless they have been given supervision or instruction concerning the use of the appliance by a person responsible for their safety.
- Children should be supervised to ensure that they do not play with the appliance.
- Do not operate any appliance with a damaged cord or plug or after the appliance malfunctions, or has been dropped or damaged in any manner. If the power cord is damaged, it must be replaced by the manufacturer, its service agent, or similarly qualified persons to avoid a hazard.
- When using electrical appliances, basic safety precautions should always be followed to reduce the risk of fire, electric shock, and/or injury.
- Do not immerse appliance, cord or plug in water or other liquid.
- Unplug from the outlet when not in use and before cleaning.
- Do not unplug the appliance by pulling on the cord.
- Use the accessories from the appliance only, as other accessories not from the appliance may cause fire, electric shock or injury.
- Use the appliance in a place with the temperature of 4 above and wet place, such as near the furnace/ bathroom.
- Press or tread the power line with the article.
- Prohibited to dismantle, refitor repair the appliance without permission.
- Use the appliance without chassis or by putting it down.
- Do not put the appliance in an uneven place or cushion such foreign matters as foam at its bottom.
- The plug must be pulled out when the product is not used for a while or is moved.
- Do not place the product in a place where a curtain may be absorbed or covered.
- It is strictly prohibited to spray or swipe the pesticide or acid substances.
- During in use, it is strictly prohibited to cover any article.
- It is strictly prohibited to blow facing the furnace or gas.

Attention:

- If the flexible power line is damaged, in order to avoid dangers, it must be replaced by its manufacturer, its Maintenance Department or similar professional technician.
- Before dismantling the protective case, please make sure that the fan is disconnected with the power supply.

CLEANING AND MAINTENANCE

Cleaning

- Be sure to unplug from the electrical supply source before cleaning.
- Plastic parts should be cleaned with a soft cloth moistened with mild soap. Thoroughly remove soap film with a dry cloth.

Maintenance

The fan requires little maintenance. Do not try to fix it by yourself.

- Before cleaning and assembling, the fan must be unplugged.
- To ensure adequate air circulation to the motor, keep vents at the rear of the motor free of dust. Do not disassemble the fan to remove dust.
- Please wipe the exterior parts with a soft cloth soaking a mild detergent.
- Do not use any abrasive detergent or solvents to avoid scratching the surface.
- Do not use any of the following as a cleaner: gasoline, thinner.
- Do not allow water or any other liquid into the motor housing or interior parts.

TROUBLESHOOTING

Problem	Cause of Issue	Solution
The appliance is not working	Power cord is unconnected.	Connect the power cord.
	There is no power from socket.	Check socket is turned on.
	The power switch is not on	Turn the unit on.

Operation

Power Switch:

- After the power supply is connected, press the button, "⏻", the fan will be started at a medium gear and work at a low gear, and the power button and wind speed button will light up.
- Press the button again, "⏻", all working states of the fan will be stopped and the button light will go off.

Speed:

- Under the startup state, press this button, "⏸", for selecting the wind speed needed.

Note:

- The revolving speed switch may be used for regulating the wind speed according to the actual requirements and selecting the low gear, low-gear head shaking, medium gear, medium-gear head shaking, high gear and high-gear head shaking and OFF is the stop gear.

Oscillation:

- Press the button, "↺", to turn on or off the left and right auto-oscillation. The light indicates the mode state.

Timer:

- Press the button, "⌚", and the time of countdown required may be set and the timer button light will light up.

Mode:

- Press the button, "🌀", and the natural and sleep wind may be selected according to the requirements.

Remote Control:

- The remote control is effective up to 5m.
- The remote control must face the receiver to be effective.
- Please store the remote control properly and avoid impact.

PRODUCT TECHNICAL PARAMETERS

MODEL	RATED VOLTAGE	RATED POWER	AIR VOLUME	MAX AIR FLOW
MFD1803R	220-240V~ 50-60Hz	40W	36.7 m ³ /min	5.6 m/s

INTRODUCTION OF PARTS

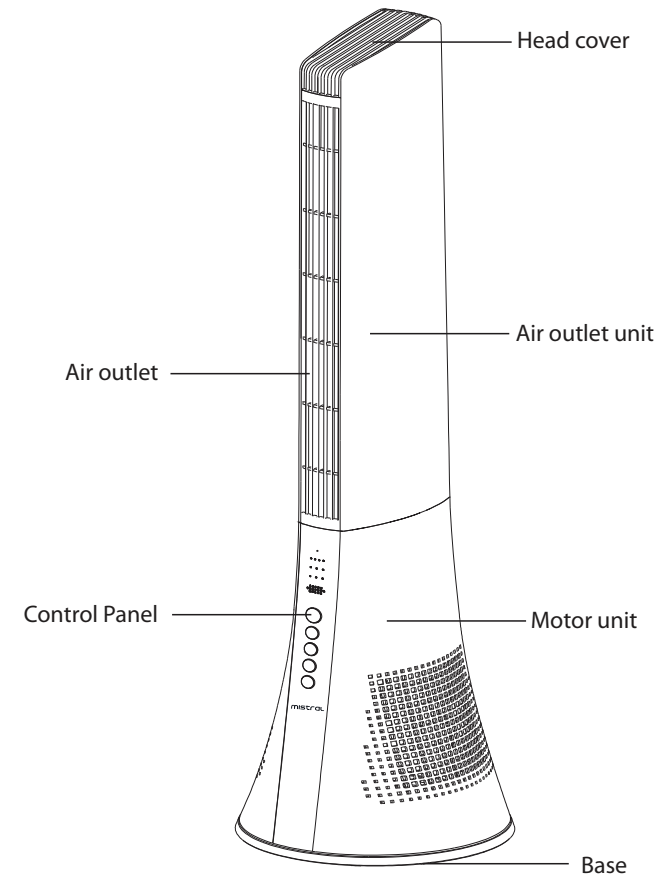

Control Panel



ON / OFF



OSC



TIMER



MODE



SPEED

Remote Control

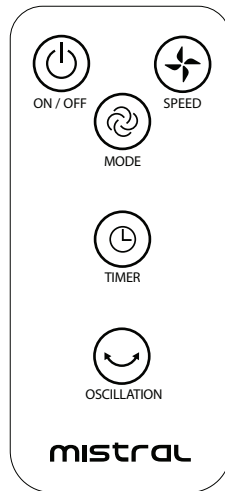

CONTROLS AND OPERATIONS

- Installation of main motor: Align six snap joints on the body of the air outlet with six snap joint holes on the appliance engine, and push the air outlet toward the panel, until it is aligned with the panel. Then, after the appliance is installed (the method to dismantle the appliance body of the air outlet is reverse to the above mentioned order) Please refer below.

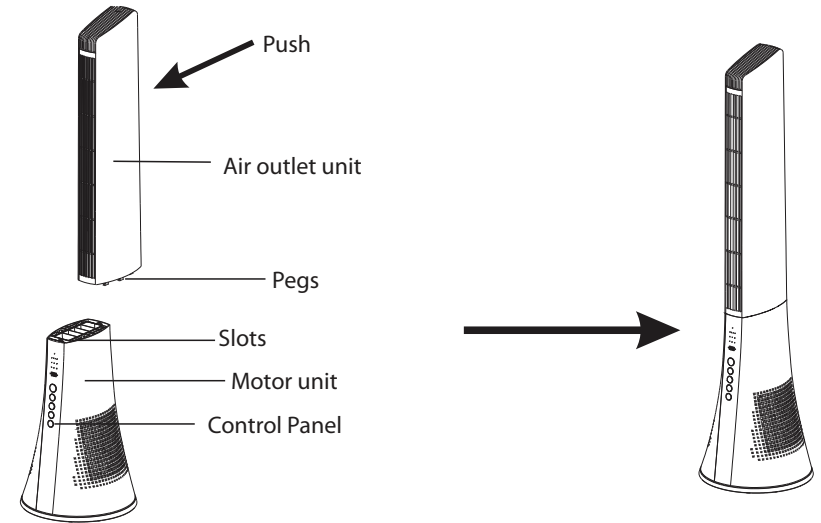

- This appliance has 3 types of speed and modes, including oscillation and timer functions.

